

Sensor Wells

Sensor Wells are used to adapt tubular proximity sensors to a wide variety of vessels for level detection applications. Different style wells allow a variety of attachment options. Sensor Wells keep systems sealed prior to sensor installation, as well as during sensor removal. Reliability and performance is improved because the sensor is isolated from the system fluid(s) or material(s).



Features

- Delrin®, HDPE and Teflon® models
- Accommodates all sensor diameters
- Six types including Flange Mount, SAE & NPT threads
- Casted welding flange accessories

Benefits

- Isolates sensor from system fluids / materials
- Highly reliable sealing method
- Simplifies sensor changeout process
- Extends the sensor operating lifetime

Typical Application

At right is a partial tank cross-section with a Weld Flange (see pg. 11) welded through the tank wall. It holds our SAE type Sensor Well. This assembly reliably seals the tank (with or without the sensor) and isolates the sensor from the tank's contents.

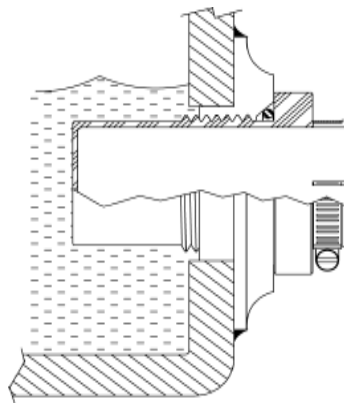

Types of Sensor Wells

Type	Description	Attachment
FM	Flange Mount	Bolts on via 4-bolt flange
PT	NPT Thread	Threads into pipe couplings
SAE	SAE Thread	SAE thread with O-ring
BH	BulkHead	Through hole mounting
CT	Conduit Type	Threads into conduit or pipe
WO	Weld-On	Welds onto plastic tanks

(Plus any customs upon request)

Flange Mount Models Specifications

Model No.	A
SW-FMSB-30	30.1(1.19)
SW-FMSB-32	32.1(1.26)
SW-FMSB-34	34.1(1.35)

Notes- Flange Mount Smooth Bore (FMSB) models are fabricated using UHMW polyethylene. The O-ring, with an OD of 88.0(3.46), produces the seal and is supplied with Sensor Well.

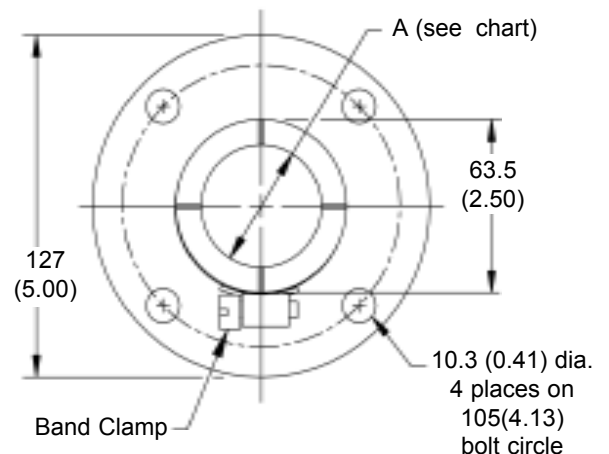
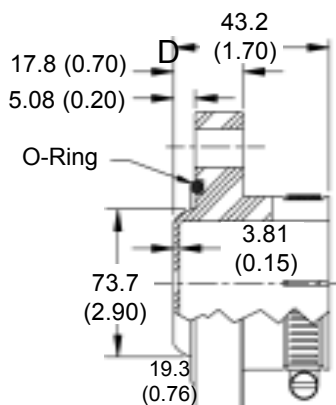

Sensor Wells

SW-PTSB model sensor wells are fabricated from either Delrin® or Teflon®. Specify material type by adding a “D” or “T” suffix to model number, for example “SW-PTSB-12-D”. Weld flanges to aid the installation of these wells are available, see page 18.

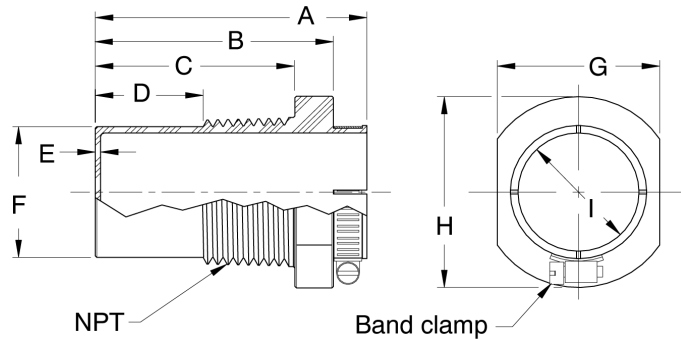

Model	A	B	C	D	E	F	NPT	G	H	I
SW-PTSB-12	44.5 (1.75)	33.0 (1.30)	26.7 (1.05)	9.14 (0.36)	0.76 (0.03)	17.8 (0.70)	1/2 x 14	25.1 (0.99)	31.8 (1.25)	12.1 (0.48)
SW-PTSB-18	59.7 (2.35)	48.1 (1.90)	38.9 (1.53)	16.5 (0.65)	1.27 (0.05)	22.6 (0.89)	3/4 x 14	31.5 (1.24)	37.3 (1.47)	18.1 (0.71)
SW-PTSB-30					1.91 (0.08)	36.6 (1.44)	1-1/4 x 11.5	44.5 (1.75)	50.0 (1.97)	30.1 (1.19)
SW-PTSB-32	59.7 (2.35)	48.1 (1.90)	38.9 (1.53)	19.3 (0.76)	2.03 (0.08)	41.1 (1.63)	1-1/2 x 11.5	56.9 (2.24)	63.2 (2.49)	32.1 (1.26)
SW-PTSB-34										34.1 (1.34)

SW-SAESB-18-D - Fabricated from Delrin®. Call for additional sizes. See page 18 for a mating weld flange.

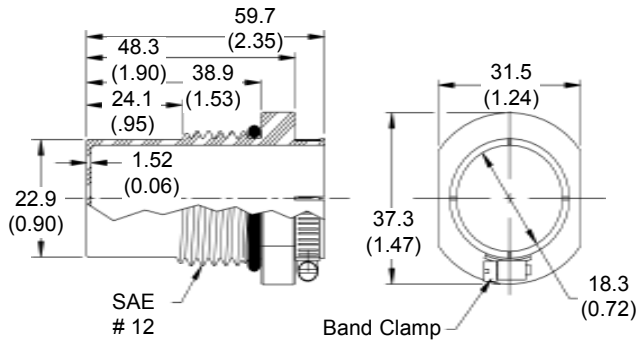

SW-CTTB-30-T - Fabricated from Teflon®. Call for additional sizes and or different materials.

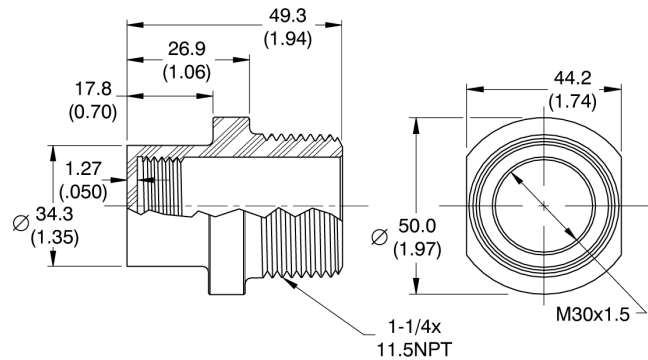

SW-BHSB-30-D - Well & nut fabricated from Delrin®. Gaskets supplied. Call for additional sizes.

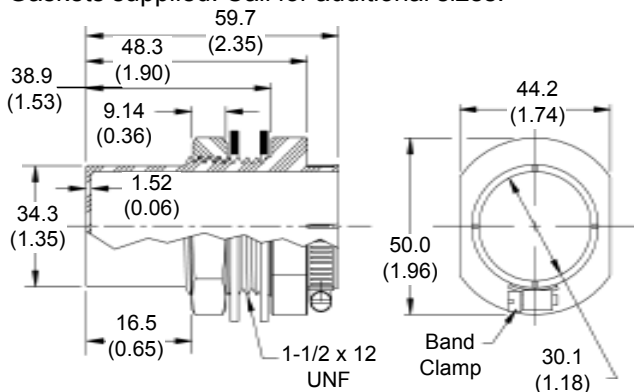

SW-WOSB-30-”XX” - Specify “PE” for polyethylene or “PP” for polypropylene. Call for datasheet for additional sizes.

